

FLAP VALVE

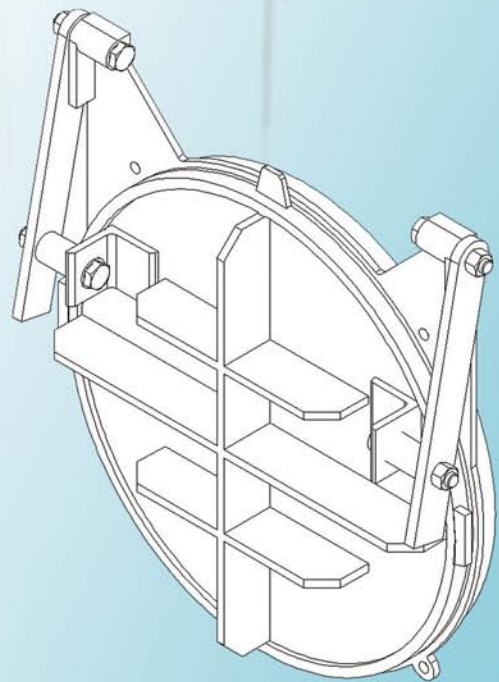

MODEL: FGA - 25



MODEL: FGB - 30

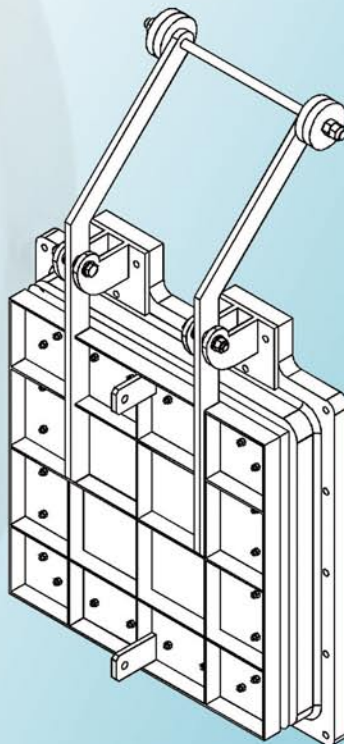

MODEL: FCC - 35

FGB-30 Flap Valve

Feature

- ❖ Economical backflow prevention perfect for low head applications.
- ❖ Double pivot hinge action provides positive seating.
- ❖ Rugged Cast Iron seat and cover.
- ❖ Versatile for mounting to headwalls or corrugated pipe.
- ❖ Balanced design ensures maximum responsiveness.
- ❖ Precision machined and ground seating Surfaces,

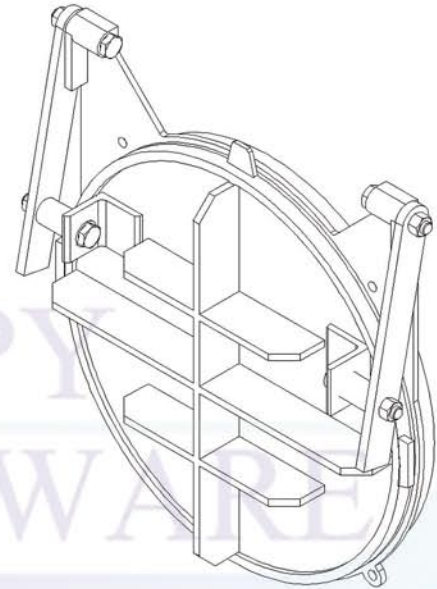

FGB-30 Flap Valve

Material Specifications

Item	Description	Material	Specification
1	Frame	Cast Iron	ASTM A126 Class B
2	Cover	Cast Iron/ Rolled steel	ASTM A126 Class B/ ASTM A36
3	Link	Steel	ASTM A36
4	Bushing	Bronze	ASTM B505
5	Hinge Bolt	Stainless steel	ASTM A276 Type 304
6	Nut	Stainless steel	ASTM A276 Type 304
7	Washer	Stainless steel	ASTM A276 Type 304

Subject to modifications

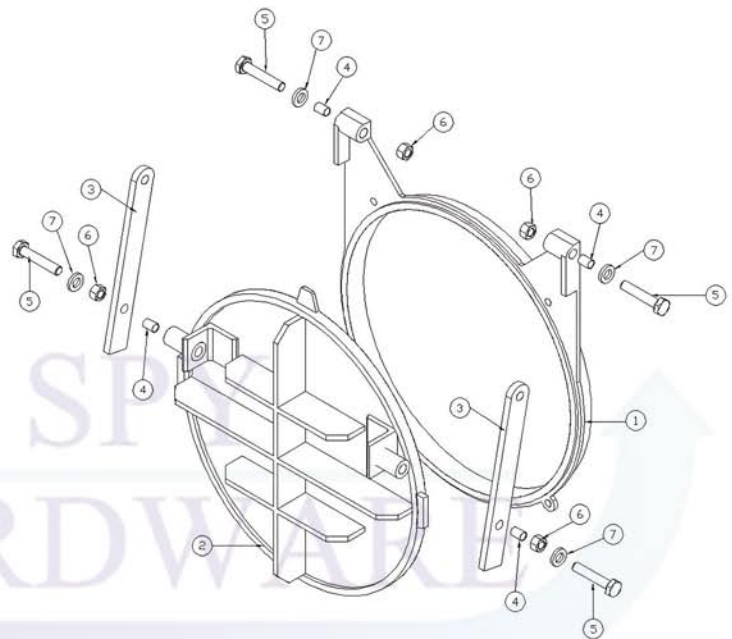

Applications

FGB - 30 Flap Valve is designed to permit the outflow of water from a pipe or a structure to a body of water while preventing backflow of the same. It is frequently used in reservoirs, tidal basins, ponding basins, pump stands and storm drain Systems where seating heads are less than ten feet.

FGB-30 Flap Valve

SPY

Pressure Rating

Maximum seating head10 ft.

Installation

FGB – 30 Flap Valve is normally installed on corrugated steel pipe or bolted to a concrete head wall or a steel flange. When attached to corrugated steel pipe the spigot back style seat is used. This style seat allows for a simple bolted connection to the pipe or the use of a rod and lug harness assembly to mount the gate to the pipe. In either case mastic is used to seal the joint. When mounted to a concrete headwall the flat back style seat is used in conjunction with embedded anchor bolts to locate, align and support the gate. A one inch space between the seat and concrete is grouted after the Gate has been mounted on the anchor bolts. The flat back Style seat can also be machined and drilled to match a partial pattern of a standard 25 lb, or 125 lb. flange.

Options

- Flat back for headwall or flange mounting,
- Spigot back for Corrugated pipe
- Bronze seating surfaces,
- Stainless Steel links / bushings / fasteners,
- Special coatings

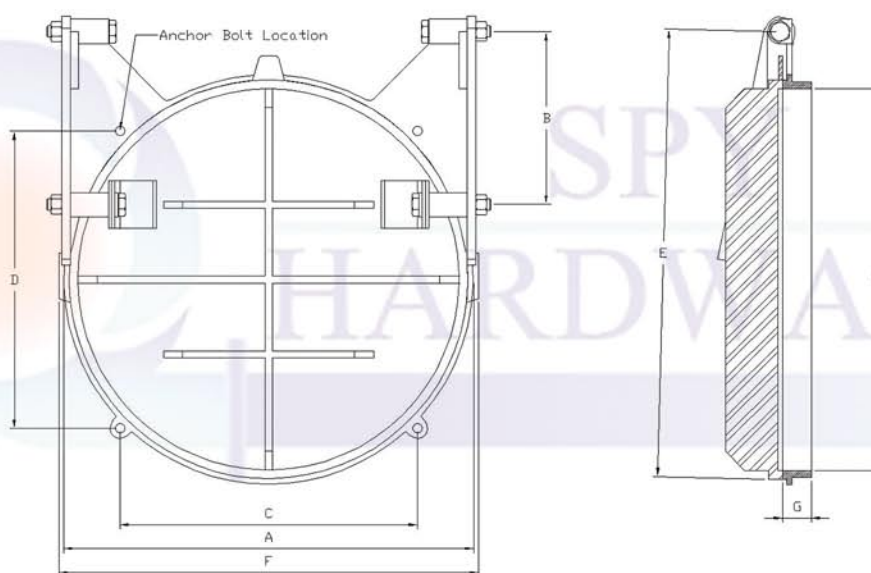

Dimensional Information

Valve Size (Inches)	Dimensions (Inches)								Anchor Bolt Data	
	A	B	C	D	E	F	G	H	Qty.	Size
16	410	160	300	300	520	430	60	400	4	22
24	630	280	425	425	750	660	60	600	4	22
32	830	360	625	625	1000	880	60	800	4	25
40	1030	480	830	830	1300	1100	60	1000	4	28

Subject to modifications