

# FLAP VALVE

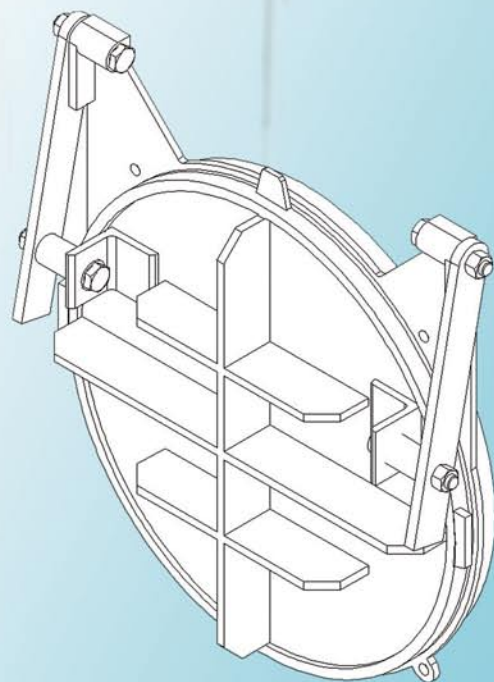

**MODEL: FGA - 25**



**MODEL: FGB - 30**

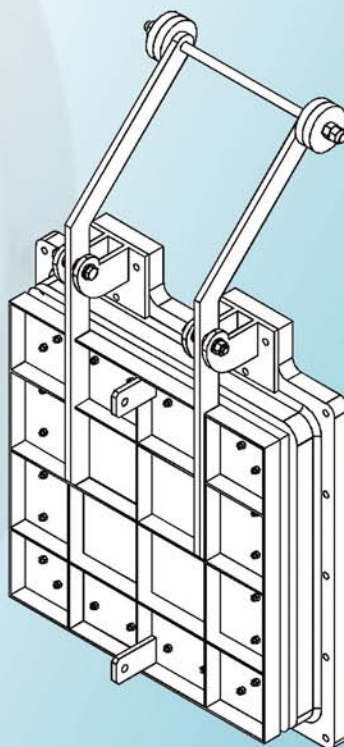

**MODEL: FCC - 35**

# FGA - 25 Pump Flap Valve

## FOR PUMP DISCHARGE

- ❖ EASY-ON COMPRESSION MOUNTING OR STANDARD PN10 FLANGE FRAME
- ❖ CAST IRON OR ALUMINUM FLAP COVER
- ❖ GROUND NEOPRENE, BRONZE, OR IRON SEATS FOR TIGHT SEALING
- ❖ 85% SEATING ANGLE
- ❖ FULL-OPENING

## USES:

Model FGA-25 Pump Flap Valve is furnished in various styles to fit most installation needs. The FGA-25 Pump Flap Valve is also available with a flanged frame drilled for PN 10 standard mounting

## FEATURES:

The body is cast iron. Hinge bars, bearing washers and cotter pins are brass. There are positive stops to prevent jamming. The modest price of this free-opening, tight-closing valve makes it a noteworthy unit.

Flange style available in 4" - 48" diameter.



For Model FGA-25, specify gaskets for:  
standard size pipe (OD sizes 4 " , 6" , 8 " , 10" , 12" , 14" , 16" – 48" )

# FGA - 25 Flap Valve

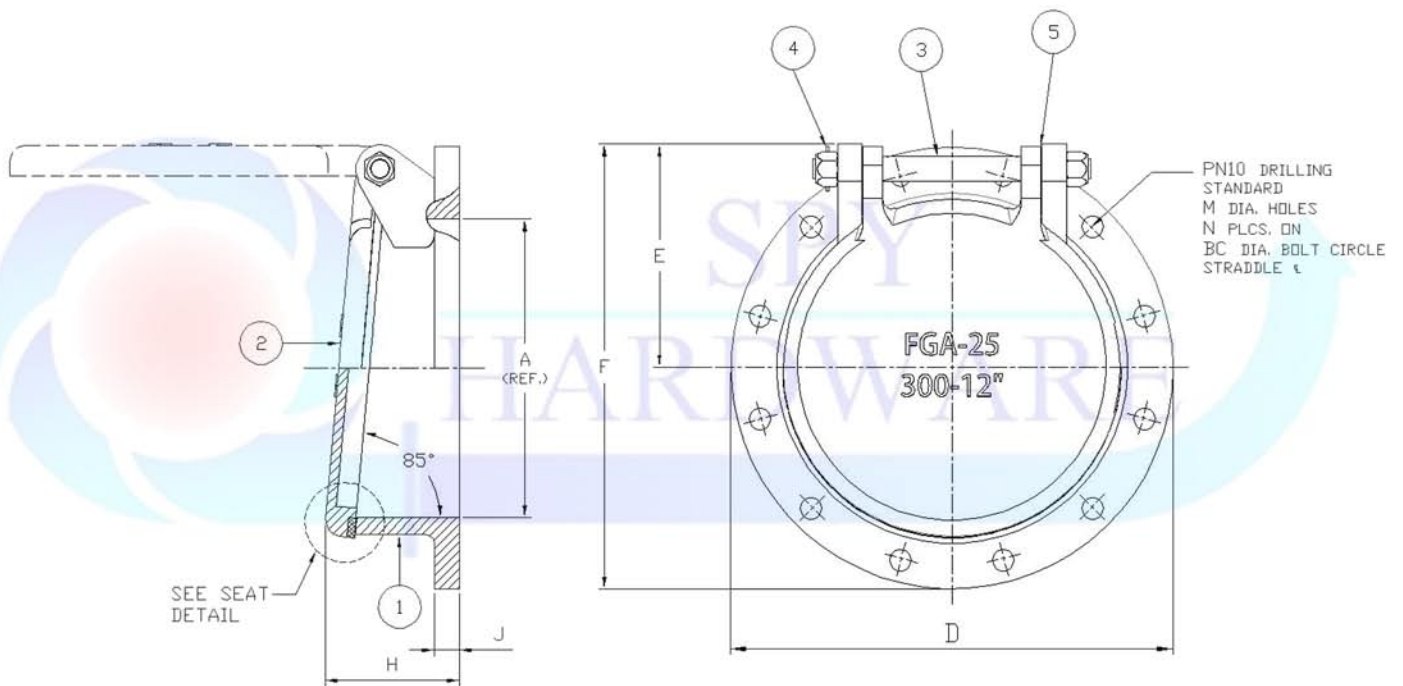

RESILIENT SEAT  
IN COVER.  
MACHINED IRON  
SEAT BODY\*

RESILIENT SEAT  
IN COVER.  
BRONZE SEAT  
IN FRAME



MACHINED IRON

Item	Description	Material	Specification
1	Frame	Cast Iron/ Rolled steel	ASTM A126 Class B/ ASTM A36
2	Cover	Cast Iron/ Rolled steel	ASTM A126 Class B/ ASTM A36
3	Hinge Pin	Stainless steel	ASTM A276 Type 304
4	Spring Pin	Stainless steel	ASTM A276 Type 304
5	Washer	Stainless steel	ASTM A276 Type 304

## GATE DIMENSIONS IN INCHES

GARE SIZE A	100(4")	150(6")	200(8")	250(10")	300(12")	350(14")	400(16")	450(18")	500(20")	550(24")	TO ORDER
BC	170	225	295	350	400	460	515	565	620	725	
D	210	265	340	395	445	505	565	615	670	780	
E	100	130	170	175	220	250	280	300	335	390	
F	210	265	340	395	445	500	560	615	670	780	
H	50	55	85	90	100	120	120	145	150	180	
J	10	10	20	22	25	25	25	30	30	30	
M	18	18	22	22	22	22	26	26	26	30	
N	4	8	8	12	12	16	16	20	20	20	

Subject to modifications



# FGB-30 Flap Valve

## Feature

- ❖ Economical backflow prevention perfect for low head applications.
- ❖ Double pivot hinge action provides positive seating.
- ❖ Rugged Cast Iron seat and cover.
- ❖ Versatile for mounting to headwalls or corrugated pipe.
- ❖ Balanced design ensures maximum responsiveness.
- ❖ Precision machined and ground seating Surfaces,

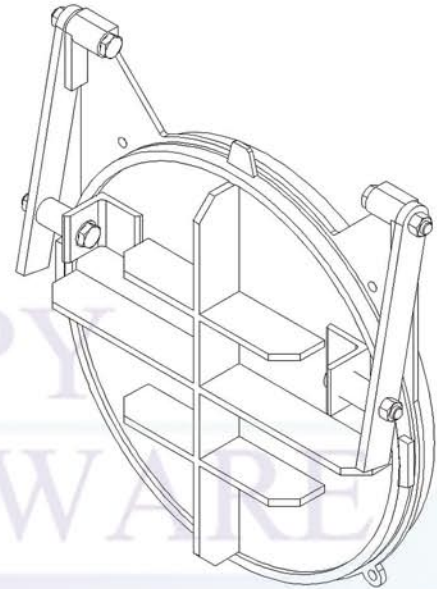

**FGB-30 Flap Valve**

## Material Specifications

Item	Description	Material	Specification
1	Frame	Cast Iron	ASTM A126 Class B
2	Cover	Cast Iron/ Rolled steel	ASTM A126 Class B/ ASTM A36
3	Link	Steel	ASTM A36
4	Bushing	Bronze	ASTM B505
5	Hinge Bolt	Stainless steel	ASTM A276 Type 304
6	Nut	Stainless steel	ASTM A276 Type 304
7	Washer	Stainless steel	ASTM A276 Type 304

Subject to modifications

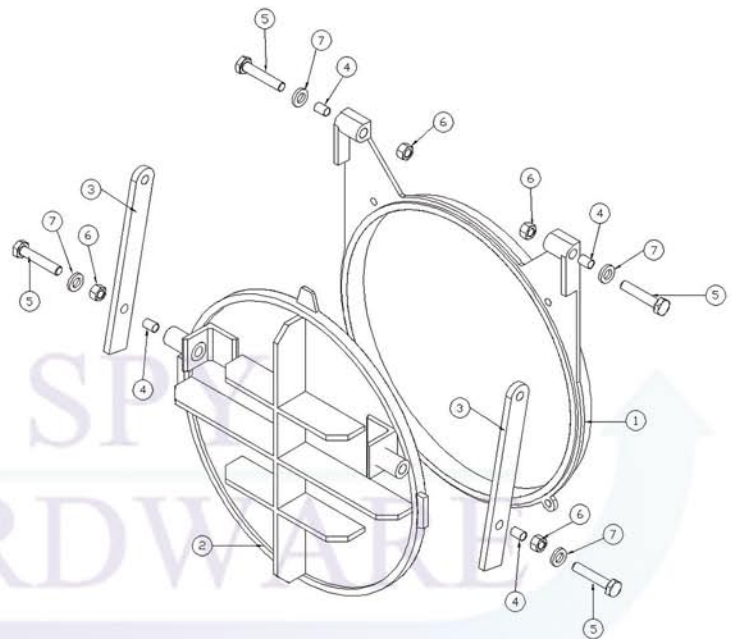

## Applications

FGB - 30 Flap Valve is designed to permit the outflow of water from a pipe or a structure to a body of water while preventing backflow of the same. It is frequently used in reservoirs, tidal basins, ponding basins, pump stands and storm drain Systems where seating heads are less than ten feet.

# FGB-30 Flap Valve

SPY

## Pressure Rating

Maximum seating head .....10 ft.

## Installation

FGB – 30 Flap Valve is normally installed on corrugated steel pipe or bolted to a concrete head wall or a steel flange. When attached to corrugated steel pipe the spigot back style seat is used. This style seat allows for a simple bolted connection to the pipe or the use of a rod and lug harness assembly to mount the gate to the pipe. In either case mastic is used to seal the joint. When mounted to a concrete headwall the flat back style seat is used in conjunction with embedded anchor bolts to locate, align and support the gate. A one inch space between the seat and concrete is grouted after the Gate has been mounted on the anchor bolts. The flat back Style seat can also be machined and drilled to match a partial pattern of a standard 25 lb, or 125 lb. flange.

## Options

- Flat back for headwall or flange mounting,
- Spigot back for Corrugated pipe
- Bronze seating surfaces,
- Stainless Steel links / bushings / fasteners,
- Special coatings

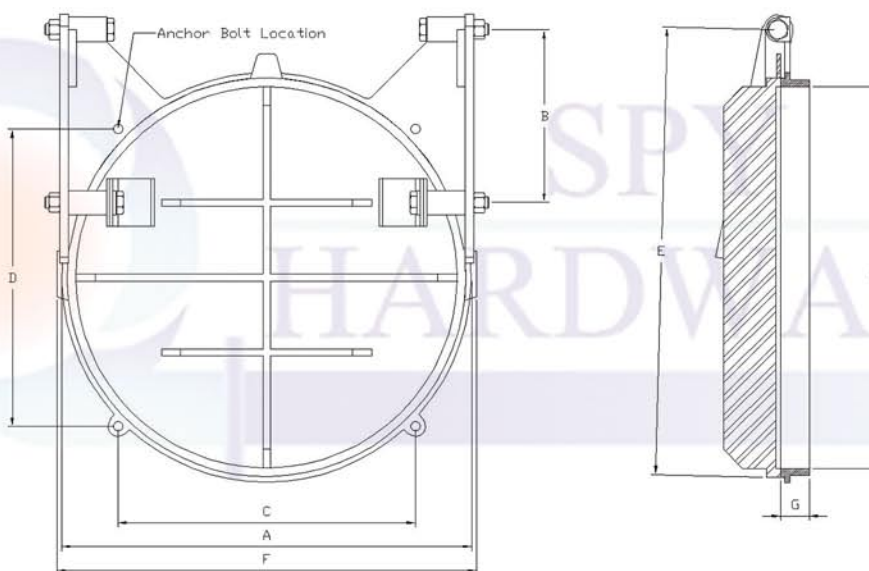

## Dimensional Information

Valve Size (Inches)	Dimensions (Inches)								Anchor Bolt Data	
	A	B	C	D	E	F	G	H	Qty.	Size
16	410	160	300	300	520	430	60	400	4	22
24	630	280	425	425	750	660	60	600	4	22
32	830	360	625	625	1000	880	60	800	4	25
40	1030	480	830	830	1300	1100	60	1000	4	28

Subject to modifications



# FGC-35 Flap Valve

## Features

- ❖ Effective backflow prevention device.
- ❖ Top hinged one way flap valve.
- ❖ Double pivot hinges as standard.
- ❖ Gravity and head pressure achieve automatic sealing.
- ❖ Low head loss.
- ❖ Full perimeter sealing.
- ❖ Suitable for up to 10m head pressure.
- ❖ Requires minimal civil works to install

## Applications

- ❖ Commonly used for tidal and flood mitigation as well as sewage and stormwater management.
- ❖ The Flap Gate range is used for many applications across all industry sectors.

## Sizes

- ❖ All SPY water control gates are custom sized to ensure they meet specific site and operational.
- ❖ requirements.
- ❖ Customisation reduces installation and civil costs.

## Operation

- ❖ Gravity and head pressure automatically operate gate for one-way flow only.

## Materials

- ❖ Constructed from marine grade 304 stainless steel.
- ❖ Suitable for corrosive tidal environments.
- ❖ Materials used in the construction of the Flap Gate range have a high corrosion resistance and can

## Dimensional Information

SIZE	A	B	C	D	E	F	G	øh	N
600	840	840	780	780	195	600	980	18	14
800	1040	1040	980	980	245	800	1180	18	14
1000	1240	1240	1180	1180	295	1000	1380	18	14
1200	1440	1440	1380	1380	345	1200	1580	18	14
1500	1740	1740	1680	1680	336	1500	1880	18	18

Subject to modifications

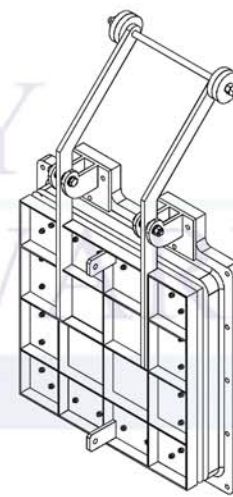

FGC-35 Flap Valve

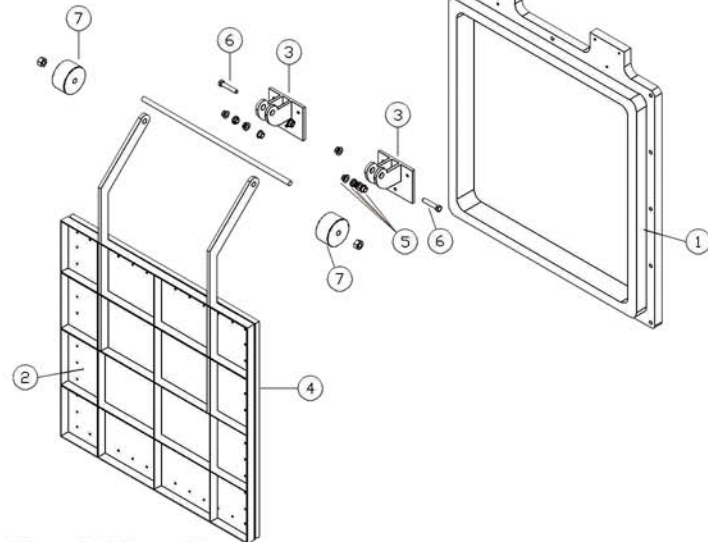

## Material Specifications

Item	Description	Material	Specification
1	GATE FRAME	Cast Iron	ASTM A126 Class B
2	GATE LEAF	Stainless steel	ASTM A276 Type 304
3	HANGER	Stainless steel	ASTM A276 Type 304
4	J - SEAL	RUBBER(NBR)	D 2000
5	BUSHING	Bronze	B 62
6	Hinge Pin	Stainless steel	ASTM A276 Type 304
7	Counter WEIGHT	steel	ASTM A36

