



GENERAL DESCRIPTION

The SPY model CC Channel Gate is designed for open channel installation with a highly versatile flow control in waste water treatment plants, irrigation, hydraulic works and hydro-electric power plants. The sealing system is incorporated on both laterals and bottom area of the slide, resulting in a perfect seal without the need of wedges on the gate. From sizes 150 mm x 150 mm to 2000 mm x 2000 mm, the CC model has a unique seal design for applications requiring accurate flow regulation and optimum performance. The maximum leakage rate is lower the maximum allowable recommended by DIN 19569-4 (class 5) and AWWA C561 under normal conditions. The frame of the CC model is typically embedded in a concrete channel for both uni-directional or bi-directional sealing. SPY can also offer different mounting options such as wall mount and existing channel mount where required. Our engineering team can also design and manufacture the CC model channel gate in larger dimensions and for higher service conditions. For more information, please contact an SPY representative.



CONSTRUCTION DESIGN

- Size 150x150 to 2000x2000 mm (Larger size please specify)
- Head 10 m for on seating, 6 m for off seating (Higher head please contact manufacturer)
- 50% of Max. allowable leakage recommended by AWWA C561
- Shop testing : Open-close test, Seal clearance inspection, Leakage test (on request)
- Application : Water and Sewage treatment, Flood control
- Other requirement please specify

CC CHANNEL GATE SELECTION FORM

Customer : _____

Tag No: _____

Order Number : _____

Qty : _____

CHANNEL GATE DESIGN

(Size = Channel Width x Slide Height)

Units : **mm** ☐ **Inch** ☐

Channel Height : _____

Channel Width : _____

Slide Height : _____

ACTUATORS TYPE

- ☐ Handwheel
☐ Electric Motor
☐ Pneumatic Cylinder
☐ Hydraulic Cylinder

MATERIALS

- Frame ☐ Stainless steel ☐ Cast Iron ☐ Carbon steel
Gate ☐ Stainless steel ☐ Cast Iron ☐ Carbon steel
Stem ☐ Stainless steel ☐ Carbon steel
Seal ☐ Rubber ☐ Bronze
Floor Stand ☐ Carbon steel ☐ Cast Iron

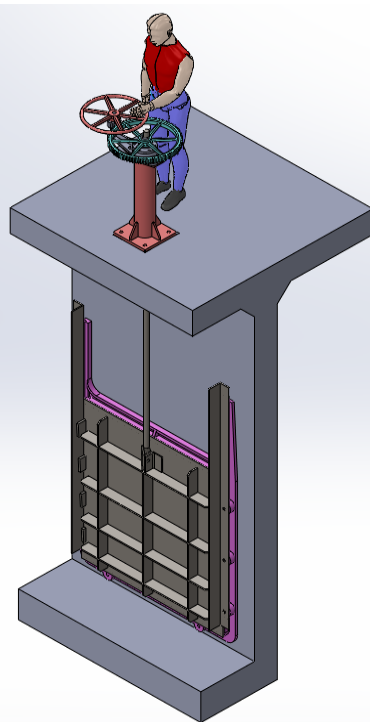
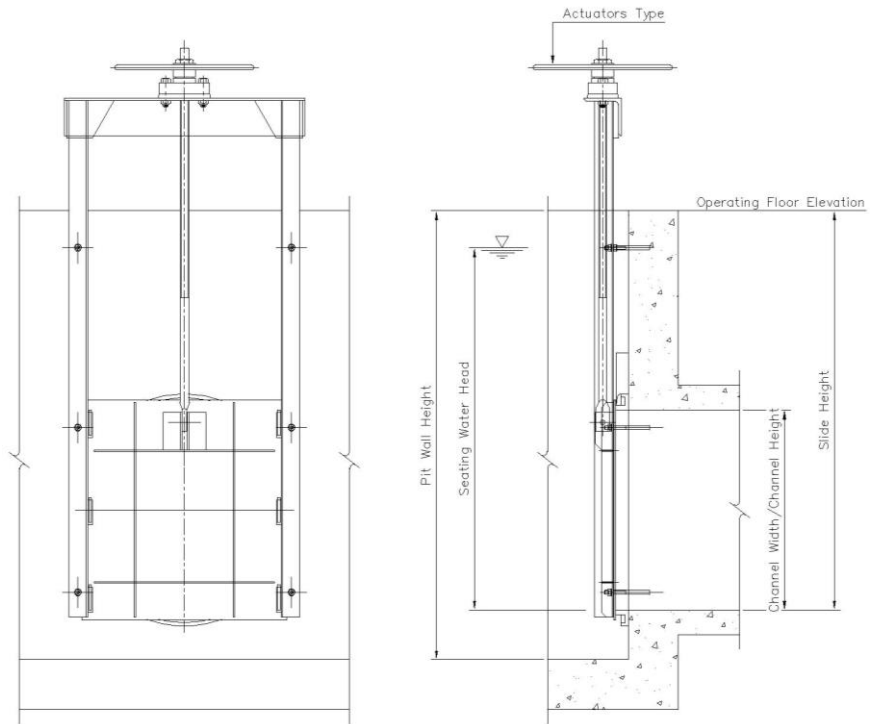

Type I

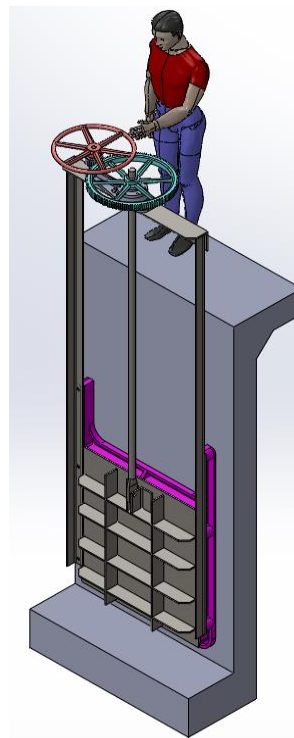

Type II

